



- 1
- 2
- 3
- 4
- 5
- 6
- 7
- 8
- 9
- 10**
- 11
- 12
- 13
- 14
- 15
- 16
- 17
- 18

**STANDARD EXECUTIONS**

- **DVA.4**: threaded stud and base plate in polished zinc-plated steel, vibration-damper body in natural rubber NR, black colour, hardness 40, 55, 70 Shore A ±5.
- **DVA.4-SST**: threaded stud and base plate in INOX AISI 304 stainless steel, vibration-damper body in natural rubber NR, black colour, hardness 55 Shore A ±5.

**FEATURES AND APPLICATIONS**

The rubber buffers have been designed to damp vibrations, shocks and noises produced by moving bodies or non-balanced vibrating masses of equipment and machines which can cause:

- malfunctioning and reduction of the machine lifespan and/or of the adjacent ones;
- damage to health;
- noise.

Load diagrams for each single code are available on request. See Technical data and guidelines for the choice (on page 728).

**SPECIAL EXECUTIONS ON REQUEST**

Natural rubber NR, hardness 40, 70 tolerance ±5 Shore A for executions with AISI 304 stainless steel base.



\* Complete the description with the desired hardness: 40, 55 or 70 tolerance ±5 Shore A.



DVA.4

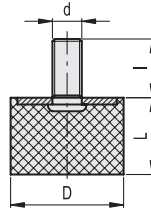

D			L		
mm	inch	mm	inch	mm	inch
8	0.31	50	1.97	8	0.31
10	0.39	60	2.36	10	0.39
15	0.59	70	2.76	13	0.51
20	0.79	75	2.95	15	0.59
25	0.98	100	3.94	17	0.67
30	1.18	125	4.92	20	0.79
40	1.57	25	0.98	75	2.95

METRIC

Description	D	L	d	l	⚖	Hardness 40 Shore A			Hardness 55 Shore A			Hardness 70 Shore A					
						Code	Max load [N]	Max deflection [mm]	Stiffness [N/mm]	Code	Max load [N]	Max deflection [mm]	Stiffness [N/mm]	Code	Max load [N]	Max deflection [mm]	Stiffness [N/mm]
DVA.4-8-8-M3-6-*	8	8	M3	6	3	415201	34	2	17	412700	55	2	28	417901	141	2	71
DVA.4-8-13-M3-6-*	8	13	M3	6	1	415205	33	3	10	412699	50	3	15	417905	133	3	41
DVA.4-10-10-M4-10-*	10	10	M4	10	2	415211	54	3	21	412701	88	3	35	417911	217	3	87
DVA.4-10-15-M4-10-*	10	15	M4	10	3	415221	69	4	18	412703	92	4	25	417921	175	4	47
DVA.4-10-20-M4-10-*	10	20	M4	10	3	415223	54	5	11	412705	95	5	19	417923	156	5	31
DVA.4-15-10-M4-10-*	15	10	M4	10	4	415231	110	2	55	412706	168	2	84	417931	410	2	205
DVA.4-15-15-M4-10-*	15	15	M4	10	5	415241	141	4	38	412709	259	4	69	417941	384	4	102
DVA.4-15-20-M4-10-*	15	20	M4	10	7	415251	134	5	27	412711	223	5	45	417951	590	5	118
DVA.4-15-30-M4-10-*	15	30	M4	10	9	415261	125	8	17	412716	258	8	34	417961	392	8	52
DVA.4-20-10-M6-18-*	20	10	M6	18	15	415271	390	3	156	412721	645	3	258	417971	940	3	376
DVA.4-20-15-M6-18-*	20	15	M6	18	10	415281	289	4	77	412741	468	4	125	417981	704	4	188
DVA.4-20-20-M6-18-*	20	20	M6	18	13	415291	258	5	52	412746	367	5	73	417991	809	5	162
DVA.4-20-30-M6-18-*	20	30	M6	18	23	415301	237	8	32	412751	420	8	56	418001	848	8	113
DVA.4-25-15-M6-18-*	25	15	M6	18	18	415311	485	4	129	412756	797	4	213	418011	1627	4	434
DVA.4-25-17-M6-18-*	25	17	M6	18	20	415321	422	4	99	412761	833	4	196	418021	1726	4	406
DVA.4-25-20-M6-18-*	25	20	M6	18	20	415331	416	5	83	412766	581	5	116	418031	1382	5	276
DVA.4-25-30-M6-18-*	25	30	M6	18	25	415341	290	8	39	412771	591	8	79	418041	1186	8	158
DVA.4-30-15-M8-20-*	30	15	M8	20	30	415351	746	4	199	412776	1023	4	273	418051	2610	4	696
DVA.4-30-17-M8-20-*	30	17	M8	20	31	415361	772	4	182	412781	1275	4	300	418061	2447	4	576
DVA.4-30-20-M8-20-*	30	20	M8	20	35	415371	567	5	113	412801	1014	5	203	418071	1878	5	376
DVA.4-30-25-M8-20-*	30	25	M8	20	38	415381	576	6	92	412811	1026	6	164	418081	1591	6	255
DVA.4-30-30-M8-20-*	30	30	M8	20	43	415391	601	8	80	412821	776	8	103	418091	1616	8	215
DVA.4-40-20-M8-23-*	40	20	M8	23	55	415401	1200	5	240	412831	2500	5	500	418101	4750	5	950
DVA.4-40-25-M8-23-*	40	25	M8	23	60	415411	1170	6	187	412836	1660	6	266	418111	4130	6	661
DVA.4-40-30-M8-23-*	40	30	M8	23	73	415421	1140	8	152	412841	1480	8	197	418121	2830	8	377
DVA.4-40-40-M8-23-*	40	40	M8	23	83	415431	995	10	100	412861	1403	10	140	418131	3150	10	315
DVA.4-50-20-M10-28-*	50	20	M10	28	90	415441	2680	5	536	412881	3460	5	692	418141	7450	5	1490
DVA.4-50-30-M10-28-*	50	30	M10	28	118	415451	1820	8	243	412901	2520	8	336	418151	5420	8	723
DVA.4-50-40-M10-28-*	50	40	M10	28	140	415461	1430	10	143	412921	2760	10	276	418161	4950	10	495
DVA.4-50-50-M10-28-*	50	50	M10	28	155	415463	1366	13	109	412923	2700	13	216	418163	4190	13	335
DVA.4-60-20-M10-28-*	60	20	M10	28	219	415471	1885	5	377	412931	3850	5	770	418171	11990	5	2398
DVA.4-60-40-M10-28-*	60	40	M10	28	295	415481	2600	10	260	412936	3540	10	354	418181	4640	10	464
DVA.4-60-60-M10-28-*	60	60	M10	28	312	415485	2530	15	169	412939	3480	15	232	418185	8110	15	541
DVA.4-70-30-M10-28-*	70	30	M10	28	280	415490	4930	8	657	412940	7170	8	956	418190	13070	8	1743
DVA.4-70-40-M10-28-*	70	40	M10	28	265	415491	3850	10	385	412941	6280	10	628	418191	15280	10	1528
DVA.4-70-55-M10-28-*	70	55	M10	28	357	415501	3320	14	241	412951	5770	14	420	418201	9510	14	692
DVA.4-75-25-M12-37-*	75	25	M12	37	223	415511	6560	6	1050	412961	9660	6	1546	418211	20780	6	3325
DVA.4-75-40-M12-37-*	75	40	M12	37	310	415521	5010	10	501	412971	6680	10	668	418221	9170	10	917
DVA.4-75-50-M12-37-*	75	50	M12	37	340	415531	3970	13	318	412981	5570	13	446	418231	13550	13	1084
DVA.4-100-40-M16-41-*	100	40	M16	41	570	415541	9430	10	943	413001	12110	10	1211	418241	24190	10	2419
DVA.4-100-50-M16-41-*	100	50	M16	41	655	415551	8320	13	666	413011	14040	13	1123	418251	22900	13	1832
DVA.4-100-60-M16-41-*	100	60	M16	41	830	415561	7440	15	496	413021	12950	15	863	418261	21450	15	1430
DVA.4-125-55-M16-41-*	125	55	M16	41	1055	415581	19700	14	1433	413025	23790	14	1730	418271	25000	14	2212
DVA.4-125-75-M16-41-*	125	75	M16	41	1425	415591	17600	19	939	413027	20123	19	1073	418281	24780	19	1322



Vibration damping elements



DVA.4 - 8 - 8 - SST - M3 - 6 - 55  
 D L Stainless steel d l Shore A

DVA.4-SST

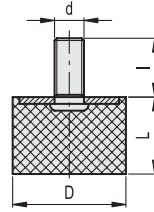

D				L			
mm	inch	mm	inch	mm	inch	mm	inch
8	0.31	50	1.97	8	0.31	30	1.18
10	0.39	60	2.36	10	0.39	40	1.57
15	0.59	70	2.76	13	0.51	45	1.77
20	0.79	75	2.95	15	0.59	50	1.97
25	0.98	100	3.94	17	0.67	55	2.17
30	1.18	125	4.92	20	0.79	60	2.36
40	1.57			25	0.98	75	2.95



Description	D	L	d	l	⚖	Hardness 40 Shore A			Hardness 55 Shore A			Hardness 70 Shore A					
						Code	Max load [N]	Max deflection [mm]	Stiffness [N/mm]	Code	Max load [N]	Max deflection [mm]	Stiffness [N/mm]	Code	Max load [N]	Max deflection [mm]	Stiffness [N/mm]
DVA.4-8-8-SST-M3-6-55	8	8	M3	6	3		34	2	17	410301	55	2	28		141	2	71
DVA.4-8-13-SST-M3-6-55	8	13	M3	6	1		33	3	10	410303	50	3	15		133	3	41
DVA.4-10-10-SST-M4-10-55	10	10	M4	10	2		54	3	21	410305	88	3	35		217	3	87
DVA.4-10-15-SST-M4-10-55	10	15	M4	10	3		69	4	18	410307	92	4	25		175	4	47
DVA.4-10-20-SST-M4-10-55	10	20	M4	10	3		54	5	11	410309	95	5	19		156	5	31
DVA.4-15-10-SST-M4-10-55	15	10	M4	10	4		110	2	55	410311	168	2	84		410	2	205
DVA.4-15-15-SST-M4-10-55	15	15	M4	10	5		141	4	38	410313	259	4	69		384	4	102
DVA.4-15-20-SST-M4-10-55	15	20	M4	10	7		134	5	27	410315	223	5	45		590	5	118
DVA.4-15-30-SST-M4-10-55	15	30	M4	10	9		125	8	17	410317	258	8	34		392	8	52
DVA.4-20-10-SST-M6-18-55	20	10	M6	18	15		390	3	156	410321	645	3	258		940	3	376
DVA.4-20-15-SST-M6-18-55	20	15	M6	18	10		289	4	77	410323	468	4	125		704	4	188
DVA.4-20-20-SST-M6-18-55	20	20	M6	18	13		258	5	52	410325	367	5	73		809	5	162
DVA.4-20-30-SST-M6-18-55	20	30	M6	18	23		237	8	32	410327	420	8	56		848	8	113
DVA.4-25-15-SST-M6-18-55	25	15	M6	18	18		485	4	129	410331	797	4	213		1627	4	434
DVA.4-25-17-SST-M6-18-55	25	17	M6	18	20		422	4	99	410333	833	4	196		1726	4	406
DVA.4-25-20-SST-M6-18-55	25	20	M6	18	20		416	5	83	410335	581	5	116		1382	5	276
DVA.4-25-30-SST-M6-18-55	25	30	M6	18	25		290	8	39	410337	591	8	79		1186	8	158
DVA.4-30-15-SST-M8-20-55	30	15	M8	20	30		746	4	199	410341	1023	4	273		2610	4	696
DVA.4-30-17-SST-M8-20-55	30	17	M8	20	31		772	4	182	410343	1275	4	300		2447	4	576
DVA.4-30-20-SST-M8-20-55	30	20	M8	20	35		567	5	113	410345	1014	5	203		1878	5	376
DVA.4-30-25-SST-M8-20-55	30	25	M8	20	38		576	6	92	410347	1026	6	164		1591	6	255
DVA.4-30-30-SST-M8-20-55	30	30	M8	20	43		601	8	80	410349	776	8	103		1616	8	215
DVA.4-40-20-SST-M8-23-55	40	20	M8	23	55	ON REQUES	1200	5	240	410351	2500	5	500	ON REQUES	4750	5	950
DVA.4-40-25-SST-M8-23-55	40	25	M8	23	60		1170	6	187	410353	1660	6	266		4130	6	661
DVA.4-40-30-SST-M8-23-55	40	30	M8	23	73		1140	8	152	410355	1480	8	197		2830	8	377
DVA.4-40-40-SST-M8-23-55	40	40	M8	23	83		995	10	100	410357	1403	10	140		3150	10	315
DVA.4-50-20-SST-M10-28-55	50	20	M10	28	90		2680	5	536	410361	3460	5	692		7450	5	1490
DVA.4-50-30-SST-M10-28-55	50	30	M10	28	118		1820	8	243	410363	2520	8	336		5420	8	723
DVA.4-50-40-SST-M10-28-55	50	40	M10	28	140		1430	10	143	410365	2760	10	276		4950	10	495
DVA.4-50-50-SST-M10-28-55	50	50	M10	28	155		1366	13	109	410367	2700	13	216		4190	13	335
DVA.4-60-20-SST-M10-28-55	60	20	M10	28	219		1885	5	377	410371	3850	5	770		11990	5	2398
DVA.4-60-40-SST-M10-28-55	60	40	M10	28	195		2600	10	260	410373	3540	10	354		4640	10	464
DVA.4-60-60-SST-M10-28-55	60	60	M10	28	312		2530	15	169	410375	3480	15	232		8110	15	541
DVA.4-70-30-SST-M10-28-55	70	30	M10	28	280		4930	8	657	410376	7170	8	956		13070	8	1743
DVA.4-70-40-SST-M10-28-55	70	40	M10	28	265		3850	10	385	410377	6280	10	628		15280	10	1528
DVA.4-70-55-SST-M10-28-55	70	55	M10	28	357		3320	14	241	410379	5770	14	420		9510	14	692
DVA.4-75-25-SST-M12-37-55	75	25	M12	37	223		6560	6	1050	410381	9660	6	1546		20780	6	3325
DVA.4-75-40-SST-M12-37-55	75	40	M12	37	310		5010	10	501	410383	6680	10	668		9170	10	917
DVA.4-75-50-SST-M12-37-55	75	50	M12	37	340		3970	13	318	410385	5570	13	446		13550	13	1084
DVA.4-100-40-SST-M16-41-55	100	40	M16	41	570		9430	10	943	410391	12110	10	1211		24190	10	2419
DVA.4-100-50-SST-M16-41-55	100	50	M16	41	655		8320	13	666	410393	14040	13	1123		22900	13	1832
DVA.4-100-60-SST-M16-41-55	100	60	M16	41	830		7440	15	496	410395	12950	15	863		21450	15	1430
DVA.4-125-55-SST-M16-41-55	125	55	M16	41	1055		19700	14	1433	410396	23790	14	1730		25000	14	2212
DVA.4-125-75-SST-M16-41-55	125	75	M16	41	1425		17600	19	939	410397	20123	19	1073		24780	19	1322

Vibration damping elements