

# Customer Information Sheet

DRAWING No.: M80-MCXXXMI-XX-XXXXL

IF IN DOUBT - ASK

©

NOT TO SCALE

THIRD ANGLE PROJECTION

ALL DIMENSIONS IN mm

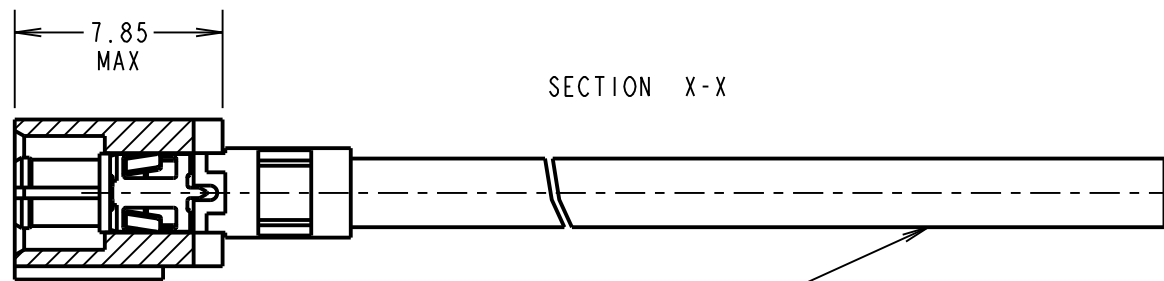
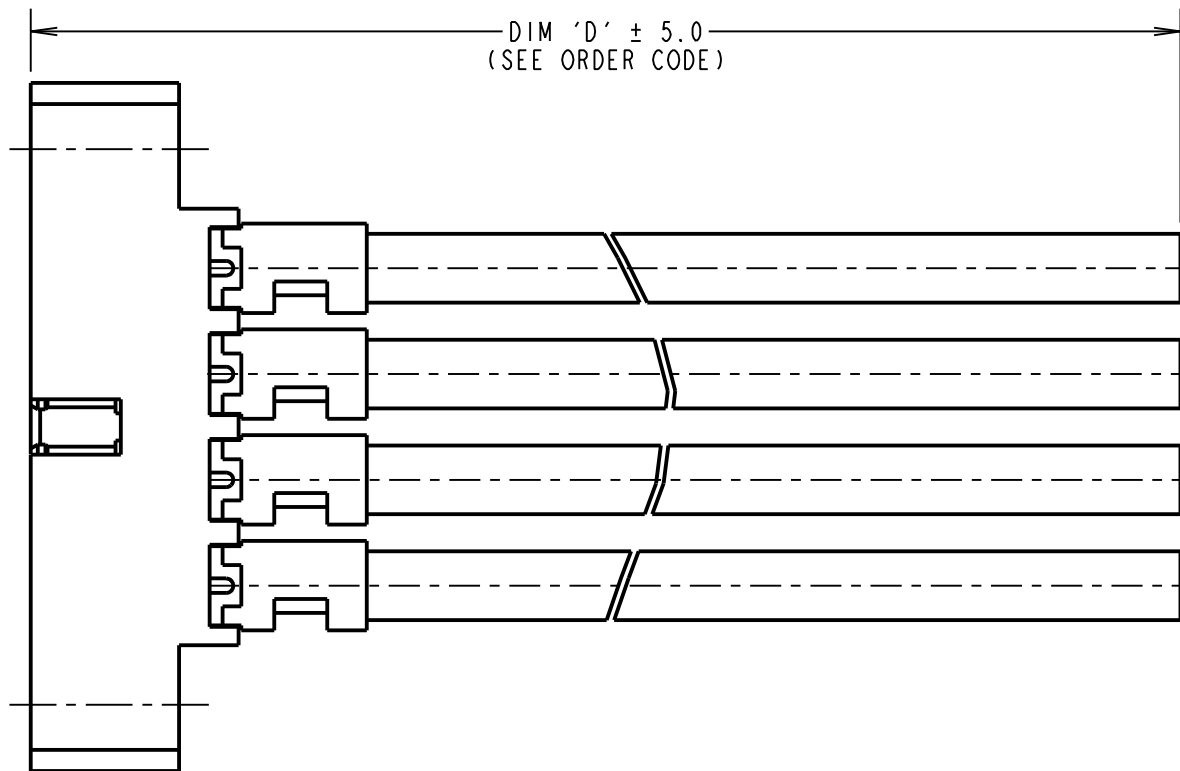
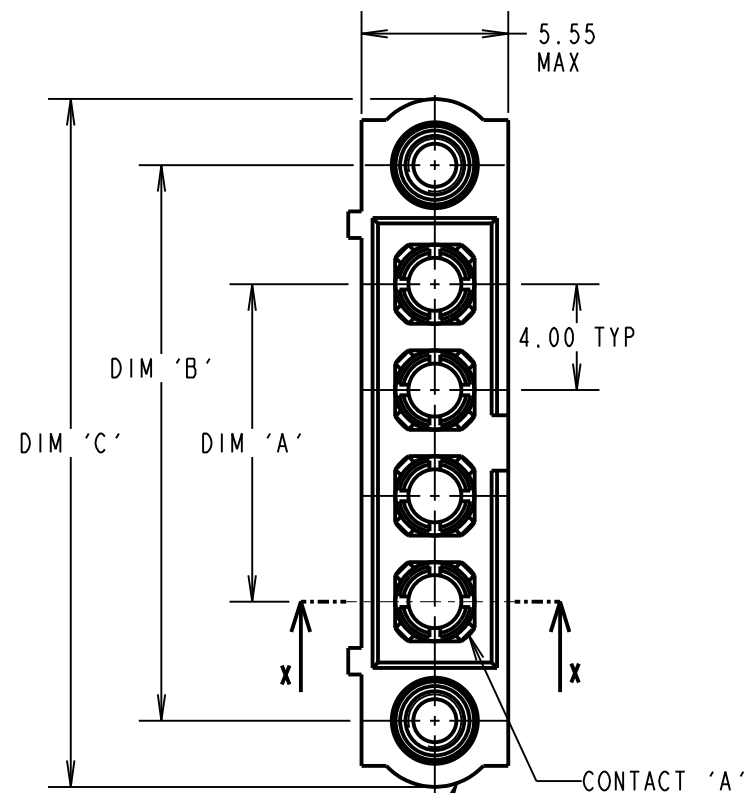

WHITE PTFE WIRE  
SEE C049XX COMPONENT SPECIFICATION  
FOR WIRE TYPE  
(SEE ORDER CODE FOR GAUGES)

**SOLDERED CONTACTS**

**CRIMPED CONTACTS**

MALE MOULDING (1-OFF):  
SEE ORDER CODE FOR TOTAL  
No. OF CONTACTS

- NOTES:  
1. CABLE ASSEMBLIES ARE BULK PACKED IN BAGS.  
2. FOR COMPLETE SPECIFICATION SEE COMPONENT SPECIFICATION  
C005XX AND C049XX (LATEST ISSUES).

DIMENSION	MEASUREMENT
DIM 'A'	(4 x No. OF CONTACTS) - 4.00
DIM 'B'	(4 x No. OF CONTACTS) + 5.00
DIM 'C'	(4 x No. OF CONTACTS) + 10.0

EXAMPLE PART No. :  
2 CONTACT CONNECTOR WITH 300mm OF 20AWG WIRE =  
M80-MC339MI-02-0300L  
10 CONTACT CONNECTOR WITH 150mm OF 10AWG WIRE =  
M80-MCPM5MI-10-0150L

**ORDER CODE: M80-MCXXXMI-XX-XXXXL**

- POWER CONTACT: \_\_\_\_\_
- 335 = POWER CONTACT SOLDER 12AWG M80-335
  - 336 = POWER CONTACT SOLDER 14AWG M80-336
  - 337 = POWER CONTACT SOLDER 16AWG M80-337
  - 338 = POWER CONTACT CRIMP 18AWG M80-338
  - 339 = POWER CONTACT CRIMP 20AWG M80-339
  - PM5 = POWER CONTACT SOLDER 10AWG M80-PM5

DIM 'D' LENGTH: \_\_\_\_\_

- 0060 = 60mm MIN
- 9999 = 9999mm MAX

(SEE TABLE FOR EXAMPLES)

TOTAL No. OF CONTACTS: \_\_\_\_\_

02 TO 12

RTP	3	11.03.21	30101
NAME	ISS.	DATE	CN/CO
APPROVED: R. PORTLOCK			
CHECKED: M. RUDKIN			
DRAWN: F. MCGOWAN			
CUSTOMER REF.:			
ASSEMBLY DRG:			



www.harwin.com  
technical@harwin.com

THIS DRAWING AND ANY  
INFORMATION OR DESCRIPTIVE  
MATTER SET OUT HEREON ARE  
CONFIDENTIAL AND COPYRIGHT  
PROPERTY OF THE HARWIN  
GROUP AND MUST NOT BE  
DISCLOSED, LOANED, COPIED  
OR USED FOR MANUFACTURING,  
TENDERING OR FOR ANY  
OTHER PURPOSE WITHOUT  
THEIR WRITTEN PERMISSION.

TOLERANCES  
X. = ±1mm  
X.X = ±0.50mm  
X.XX = ±0.20mm  
X.XXX = ±0.01mm  
ANGLES = ±5°  
UNLESS STATED

MATERIAL: SEE ABOVE  
FINISH: SEE ABOVE  
S/AREA: mm<sup>2</sup>

TITLE: DATAMATE POWER MALE  
SINGLE-ENDED CABLE ASSEMBLY  
WITH JACKSCREW

DRAWING NUMBER:  
**M80-MCXXXMI-XX-XXXXL**

SHT  
2  
OF  
2