

Features

- Vernier scale
- Black anodized w/white markings or natural aluminum (clear) anodized w/black markings
- Available with or without brake lever



KILO No.	NTE Part No.	Numeric Display	No. of Turns	Brake Lever	Finish	Diag No.
411	505-0001	Vernier	10	No	Black	D4
412	505-0002	Vernier	10	Yes	Black	D4
461	505-0003	Vernier	10	No	Clear	D4
462	505-0004	Vernier	10	Yes	Clear	D4

Features

- Vernier scale
- Black anodized w/white markings or natural aluminum (clear) anodized w/black markings
- Available with brake lever



KILO No.	NTE Part No.	Numeric Display	No. of Turns	Brake Lever	Finish	Diag No.
512	505-0005	Vernier	1	Yes	Black	D5
562	505-0006	Vernier	1	Yes	Clear	D5

KILO 400 Series

Dial – 1" diameter, 1/4" dia shaft, aluminum

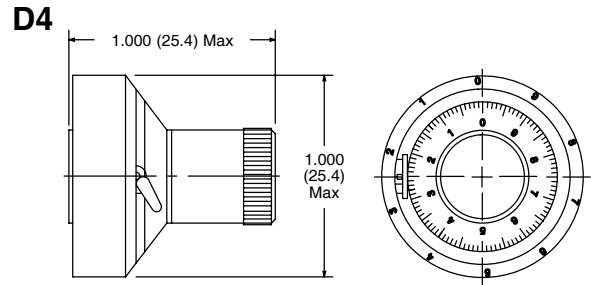

Specifications

Mechanical

1" Multi-turn dials feature easy to read primary and secondary scale, absolutely zero backlash because the index line and brake elements are secured to the panel without locating lugs and holes.

Requires only one square inch of panel space.

Shaft Bore: 0.250"

Shaft Extension Beyond Face of Panel: .600" Min, .800 Max

Bushing Extension Beyond Face of Panel: .125" Min, .297" Max thread (full thread)

KILO 500 Series

Dial – 1" diameter, 1/4" dia shaft, aluminum

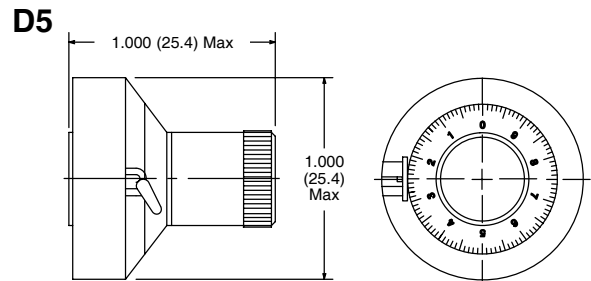

Specifications

Mechanical

1" single turn dials feature easy to read primary, absolutely zero backlash because the index line and brake elements are secured to the panel without locating lugs and holes.

Requires only one square inch of panel space.

Shaft Bore: 0.250"

Shaft Extension Beyond Face of Panel: .600" Min, .800 Max

Bushing Extension Beyond Face of Panel: .125" Min, .297" Max thread (full thread)