

# Spring Probes

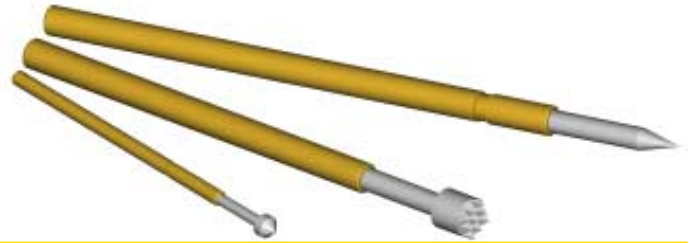

- Full technical details are available from our website: [www.harwin.com](http://www.harwin.com)

## One Part Spring Probes

**P1113CA2**  
Concave  
Radius Head  
3.00mm Centre

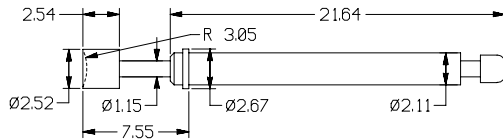

**P1113CV2**  
Convex Radius  
Head  
3.00mm Centre

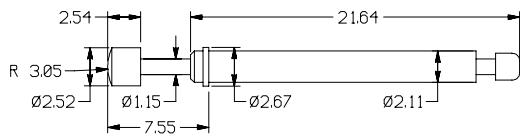

**P1113SS2**  
Convex Head  
3.00mm Centre

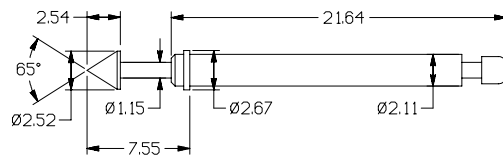

**P1342-CA**  
Concave Head  
6.00mm Centre

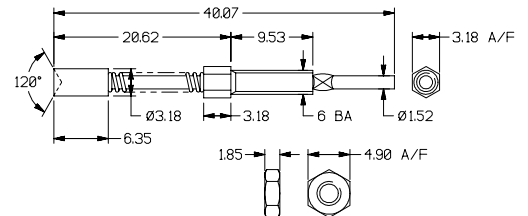

**P25-7017**  
Needle Head  
2.54mm Centre

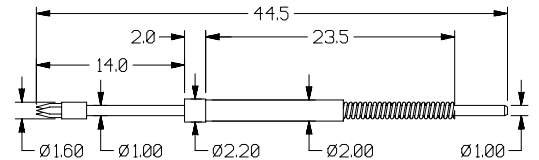

## Two Part Spring Probes - 1.27mm (.050") Centre

**P13-0123**  
Spear Head

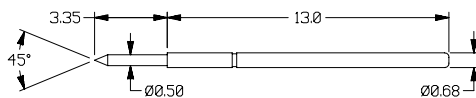

**P13-2123**  
Convex Head

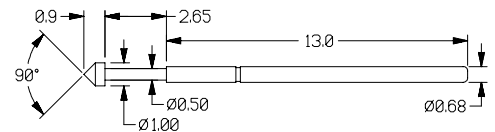

**P13-1123**  
Concave Head

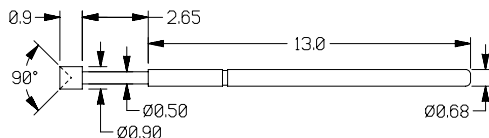

**P13-4023**  
Serrated Head

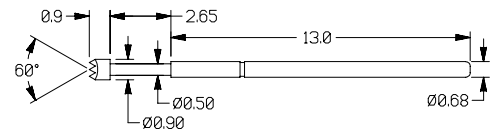

## Two Part Spring Probes - 1.90mm Pitch Centre

**P19-0121**  
Spear Head

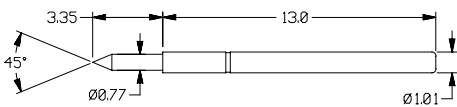

**P19-2221**  
Convex Head

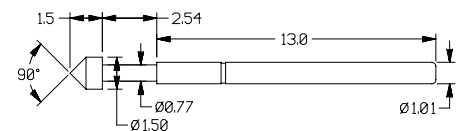

**P19-1121**  
Concave Head

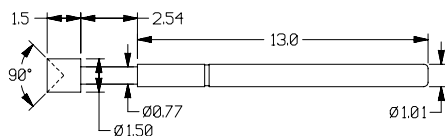

**P19-4021**  
Serrated Head

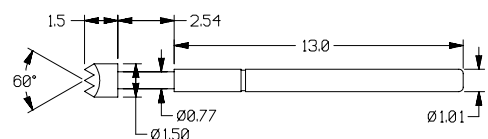

## Two Part Probes - 2.54mm (.100") Pitch Centre

**P25-0123**  
Spear Head

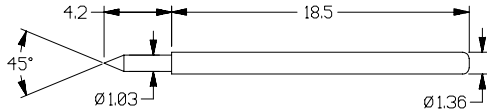

**P25-3226**  
Crown Head

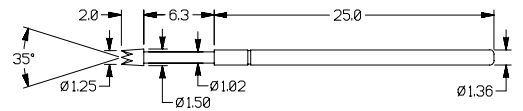

**P25-0126**  
Spear Head

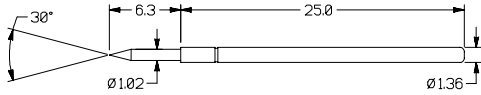

**P25-4021**  
Serrated Head

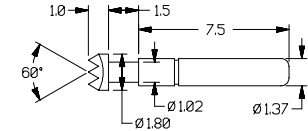

**P25-0423**  
Spherical  
Radius Head

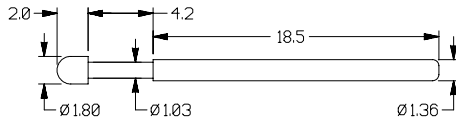

**P25-4023**  
Serrated Head

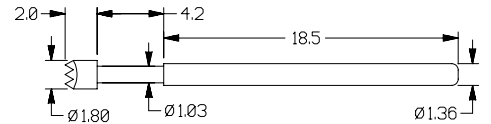

**P25-0822**  
Flat Head

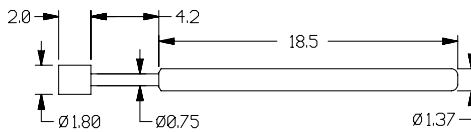

**P25-4026**  
Serrated Head

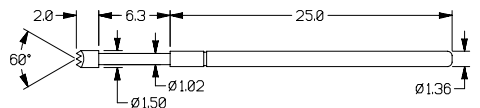

**P25-1223**  
Concave Head

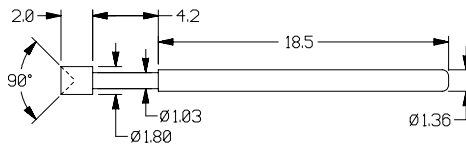

**P25-5223**  
Star Head

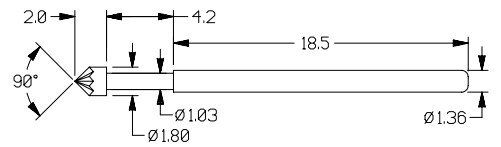

**P25-1726**  
Tulip Head

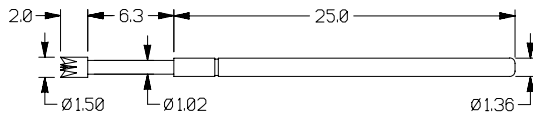

## Spring Probe Sleeves

**S13-503**  
For use with  
P13-xx23

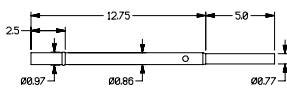

**S25-022**  
For use with  
P25-xx23/  
P25-0822

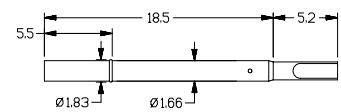

**S19-501**  
For use with  
P19-xx21

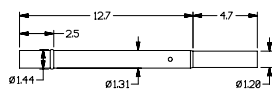

**S25-212**  
For use with  
P25-xx23/  
P25-0822

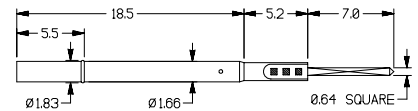

**S25-346**  
For use with  
P25-xx26

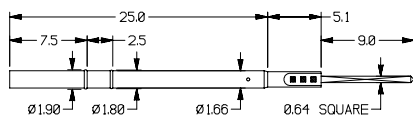

**S25-512**  
For use with  
P25-xx23/  
P25-0822

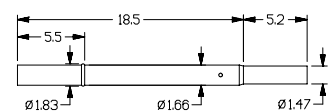

**S25-546**  
For use with  
P25-xx26

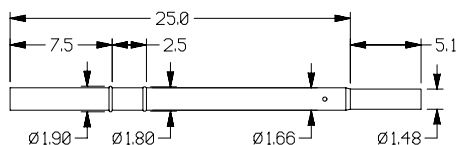

**S25-501**  
For use with  
P25-4021

