



5011 | SERIES

1/2" DISC, HERMETICALLY SEALED THERMOSTAT

Introduction

Designed to meet demanding shock and vibration requirements, the 5011 series thermostat is a RoHS compliant, positive snap action, single pole / single throw, hermetically sealed unit. Normally supplied with a grounded case construction, an additional terminal can be provided on the case for a positive ground lead or as an isolated device when the unit is insulated from ground.

The 5011 series can be used for temperature warning or protection. Calibration is factory set and is tamperproof.



Features

- Hermetic glass seal
- Ideal for surface and immersion sensing
- Multiple mounting and terminations available
- Case isolated and case grounded versions

Applications

- Printed circuit board protections
- Air or water cooled engines and transmissions
- Fluid sensing



SPECIFICATIONS

Contact Ratings	<i>Cycles</i>	<i>Voltage</i>	<i>Amps</i>	<i>Case Type</i>
	100,000	120	3 (resistive)	Ground / Insolated case
	100,000	120	2 (inductive)	Isolated case
	100,000	32	3 (resistive)	Grounded case
Contact Operations	Either close on rise (make) or open on rise (break), SPST (Single Pole, Single Throw)			
Operating Temperature	+140°F to 480°F (+60°C to 249°C)			
Temperature Tolerance	Standard of ±5°F with nominal operating temperature settings in 5°F increments			
Long Term Exposure Limit	-65°F to 625°F (-53.8°C to 329.4°C)			
	Note: Please consult the factory if lead wire/terminal exposure temperatures are expected to exceed 220°F. (Refer to inside notes B & C)			
Dielectric Strength	1000 Vrms 60Hz (isolated case) terminals to case (contacts open)			
Insulated Resistance	50 megohms at 500 Vdc			
Thermal Shock	MIL-STD-202, Method 107 Test Condition B			
Materials	Cold-rolled steel, nickel plated enclosure with a glass seal. Applications up to 300°F have a Mylar® sleeve with an epoxy fill, those above 300°F have a Nomex® sleeve and a high temperature epoxy fill.			
	*Exposure limited should be kept to within 100°F of the operating temperature. Consult factory if conditions require otherwise.			



CONTACT OPERATION

CODE	DESCRIPTION
O	Letter "O" = Open on Rise
C	Letter "C" = Close on Rise



TERMINAL SELECTION

A

Pan Head Screw Terminal, #8-32
Grounded Case Only

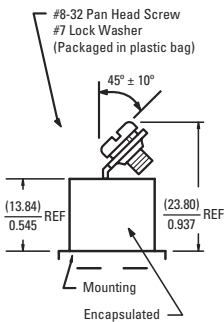
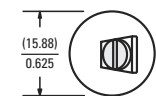

D

Quick Connect Terminal,
Grounded Case Only

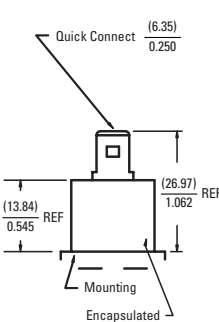

J

2 Pan Head Screw Terminals, #8-32
Isolated Case Only

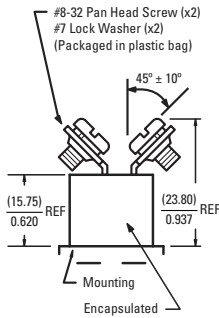
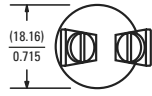

K

2 QC Terminals, Isolated Case Only

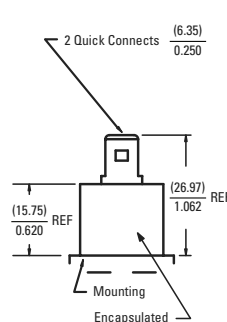
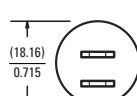

L

2 Leads, Isolated Case Only
See note 1 for lead specifications

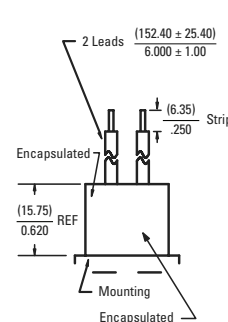
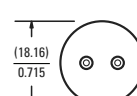

M

Same as terminal selection "L"
Except 2 Leads $\frac{304.80 \pm 25.40}{12.00 \pm 1.00}$
See note 1 for lead specifications

N

Same as terminal selection "L"
Except 2 Leads $\frac{609.60 \pm 25.40}{24.00 \pm 1.00}$
See note 1 for lead specifications

P

Same as terminal selection "L"
Except 2 Leads $\frac{1219.20 \pm 25.40}{48.00 \pm 1.00}$
See note 1 for lead specifications

Z

Special
Requirements
Customer
to Specify



TEMPERATURE CODES AND TOLERANCE

Temperature Scale	Fahrenheit	Celsius	Fahrenheit	Celsius	Fahrenheit	Celsius
Top Temperature Settings	140°F to 250°F	60°C to 121.1°C	251°F to 400°F	121.7°C to 204.4°C	401°F to 480°F	205°C to 248.9°C
Standard Top Temperature Tolerance (code)	±5°F (A)	±2.8°C (A)	±10°F (C)	±5.6°C (C)	±25°F (N)	±13.9°C (N)
Nominal Temperature Differential	25°F	13.9°C	35°F	19.4°C	40°F	22.2°C

Note

- Select any temperature in the range of 140°F to 480°F. Standard choices fall on the 5°F increments, for example 140°F, 145°F, 150°F, 155° F... up to 475°F or 480°F
- Specify the °F temperature in the part numbering scheme as a three digit code without the "°F" in the part number. For example, for 200°F, put in code "200"
- Bottom Temperature in °F equals the "Top Temperature in °F" minus "Nominal Differential in °F". For example 310°F - 30°F = 280°F

Tolerance Code	A	C	N	Y (Bottom Temp Only)
±°F	±5°F	±10°F	±25°F	Minimum
±°C	±2.8°C	±5.6°C	±13.9°C	Minimum

Note

- The standard tolerance for the top temperature is based on the temperature range the top temperature falls in, please refer to the temperature setting chart, and select the appropriate code for a standard top temperature tolerance
- For bottom temperature tolerance a "Y" = minimum trip, which indicates the "reset" trip occurs at or above the lower temperature set point.



MOUNTING AND ENCLOSURE SELECTION

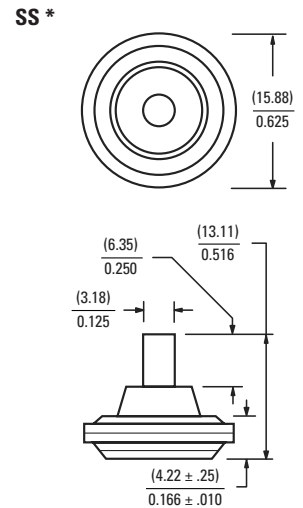
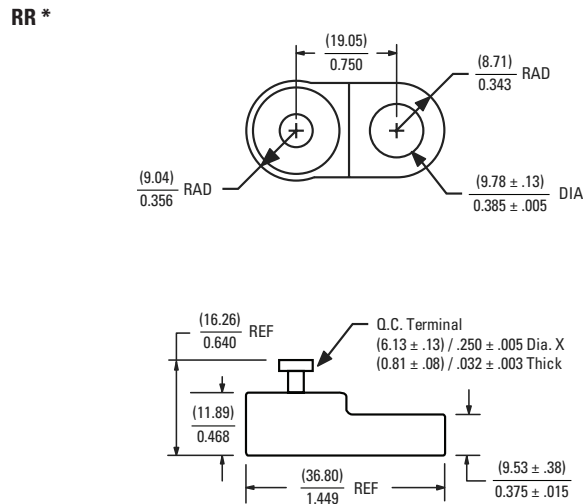
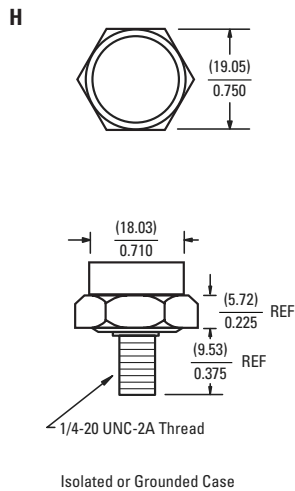
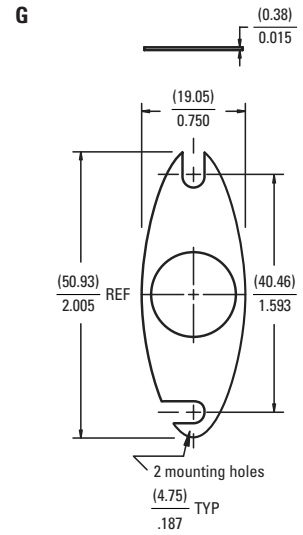
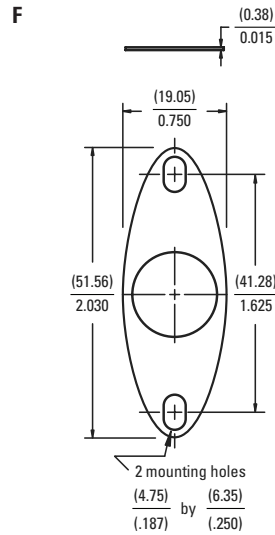
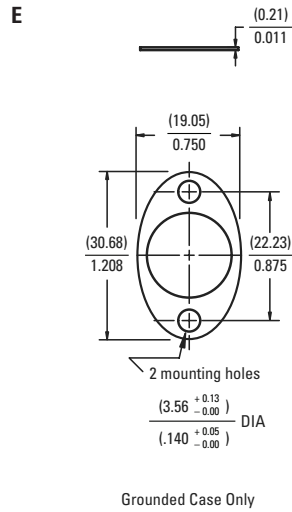
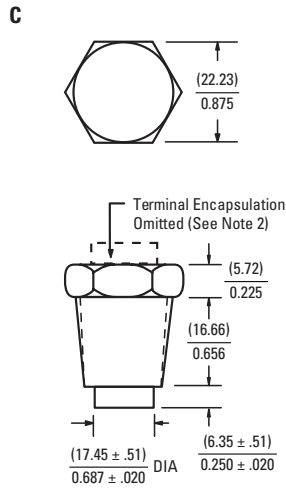

1. The standard lead wire (materials) for different temperature ranges are as follows:

- A. Up to 220°F (104.4°C) = # 18 AWG stranded. UL Style 1015/CSA approved. (PVC insulation, color black)
- B. 221°F to 350°F (105°C to 176.6°C) = #18 AWG stranded. UL Style 1199/CSA approved. (Teflon® TFE insulation, color black)
- C. 351°F (177.2°C) and above = #18 AWG stranded. UL style 5288/CSA approved. (Composite of Teflon®, ceramic + glass braid, color brown)

2. For mounting code "C" only, encapsulation above the hex is omitted and terminal height is reduced by the amount of encapsulation.

3. The marking information on each thermostat will include either the name Sensata, contact operation (CLR) close on rise, (OPR) open on rise, top temperature and date code.

*If you require either of the terminal selections "RR" or "SS", it will require the use of both position 3 (terminal selection). and position 4 (mounting and enclosure selection) in your part number building code. For example: C11RR285C-250Y



ORDERING OPTIONS

Example : C11AD285C-250Y

Close contacts on temperature rise, 5011 series, grounded case 8-32" screw terminal, mounting bracket with two 0.187" x 0.250" mounting slots, 285°F top temperature with a ±10°F standard top tolerance and a standard 35°F differential between top and bottom temperature for temperature range of 251°F to 400°F, differential helps calculate a bottom temperature of 250°F with a standard minimum reset for contacts to close at or above the bottom temperature set point.

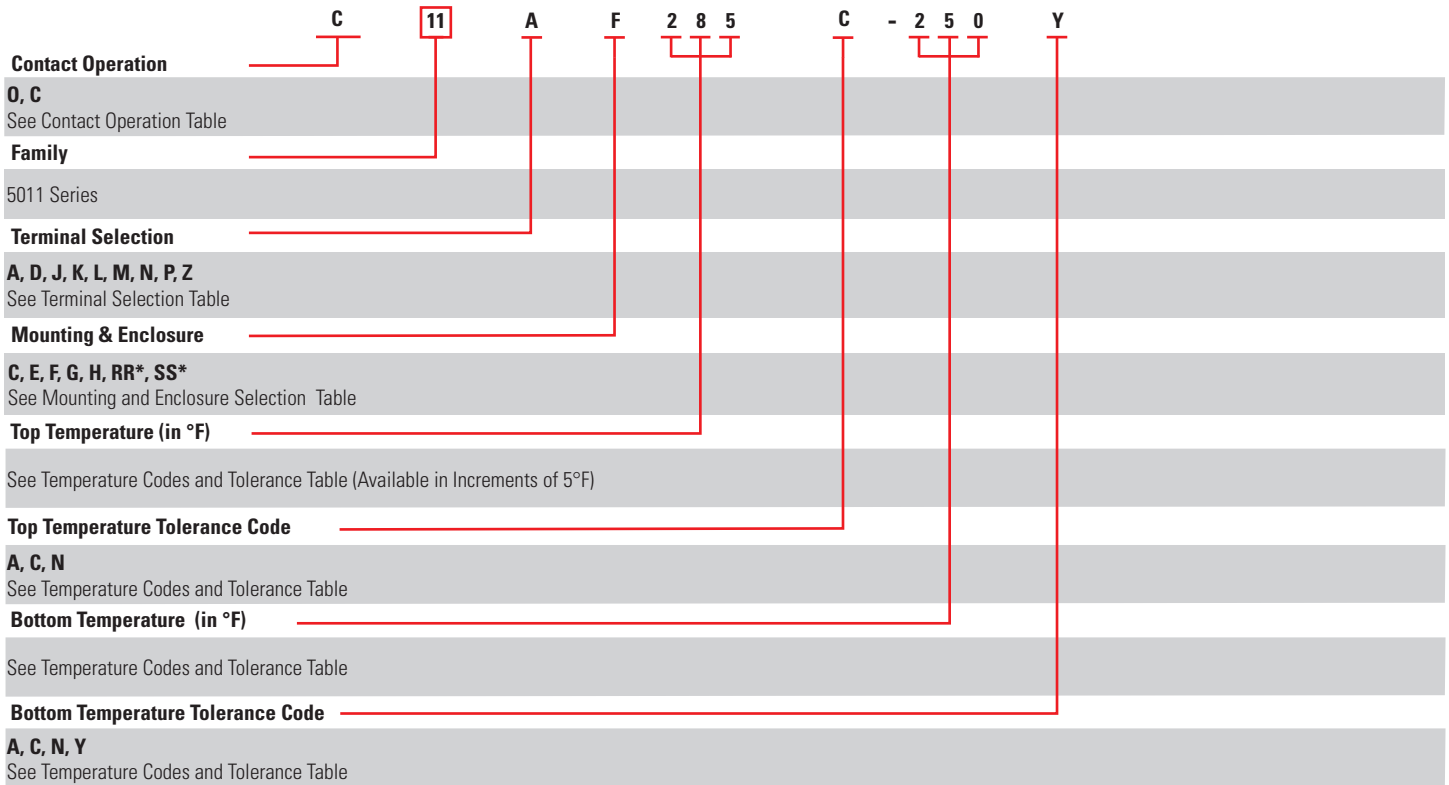

WARNINGS



RISK OF MATERIAL DAMAGE AND HOT ENCLOSURE

- The product's side panels may be hot, allow the product to cool before touching
- Follow proper mounting instructions including torque values
- Do not allow liquids or foreign objects to enter this product

Failure to follow these instructions can result in serious injury, or equipment damage.



HAZARD OF ELECTRIC SHOCK, EXPLOSION OR ARCH FLASH

- Disconnect all power before installing or working with this equipment
- Verify all connections and replace all covers before turning on power

Failure to follow these instructions will result in death or serious injury

Sensata Technologies, Inc. ("Sensata") data sheets are solely intended to assist designers ("Buyers") who are developing systems that incorporate Sensata products (also referred to herein as "components"). Buyer understands and agrees that Buyer remains responsible for using its independent analysis, evaluation and judgment in designing Buyer's systems and products. Sensata data sheets have been created using standard laboratory conditions and engineering practices. Sensata has not conducted any testing other than that specifically described in the published documentation for a particular data sheet. Sensata may make corrections, enhancements, improvements and other changes to its data sheets or components without notice.

Buyers are authorized to use Sensata data sheets with the Sensata component(s) identified in each particular data sheet. HOWEVER, NO OTHER LICENSE, EXPRESS OR IMPLIED, BY ESTOPPEL OR OTHERWISE TO ANY OTHER SENSATA INTELLECTUAL PROPERTY RIGHT, AND NO LICENSE TO ANY THIRD PARTY TECHNOLOGY OR INTELLECTUAL PROPERTY RIGHT, IS GRANTED HEREIN. SENSATA DATA SHEETS ARE PROVIDED "AS IS". SENSATA MAKES NO WARRANTIES OR REPRESENTATIONS WITH REGARD TO THE DATA SHEETS OR USE OF THE DATA SHEETS, EXPRESS, IMPLIED OR STATUTORY, INCLUDING ACCURACY OR COMPLETENESS. SENSATA DISCLAIMS ANY WARRANTY OF TITLE AND ANY IMPLIED WARRANTIES OF MERCHANTABILITY, FITNESS FOR A PARTICULAR PURPOSE, QUIET ENJOYMENT, QUIET POSSESSION, AND NON-INFRINGEMENT OF ANY THIRD PARTY INTELLECTUAL PROPERTY RIGHTS WITH REGARD TO SENSATA DATA SHEETS OR USE THEREOF.

All products are sold subject to Sensata's terms and conditions of sale supplied at www.sensata.com SENSATA ASSUMES NO LIABILITY FOR APPLICATIONS ASSISTANCE OR THE DESIGN OF BUYERS' PRODUCTS. BUYER ACKNOWLEDGES AND AGREES THAT IT IS SOLELY RESPONSIBLE FOR COMPLIANCE WITH ALL LEGAL, REGULATORY AND SAFETY-RELATED REQUIREMENTS CONCERNING ITS PRODUCTS, AND ANY USE OF SENSATA COMPONENTS IN ITS APPLICATIONS, NOTWITHSTANDING ANY APPLICATIONS-RELATED INFORMATION OR SUPPORT THAT MAY BE PROVIDED BY SENSATA.

Mailing Address: Sensata Technologies, Inc., 529 Pleasant Street, Attleboro, MA 02703, USA.

CONTACT US

Americas

+1 (888) 438 2214
sensors@sensata.com

Europe, Middle East & Africa

+31 (74) 357 8156
temperature-info.eu@sensata.com

Asia Pacific

sales.isasia@list.sensata.com
China +86 (21) 2306 1500
Japan +81 (45) 277 7117
Korea +82-10-9218-1179
India +91 (80) 67920890
Rest of Asia +886 (2) 27602006
ext 2808