

REV.	ECN NO	LOCATIONS	DESCRIPTION	DATE

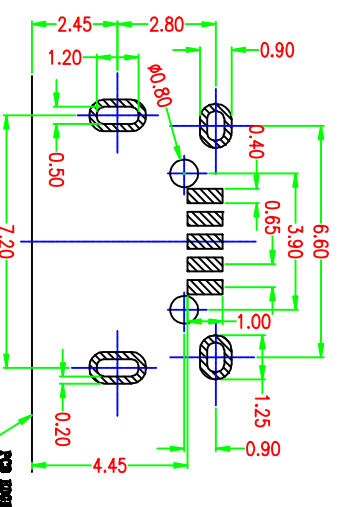
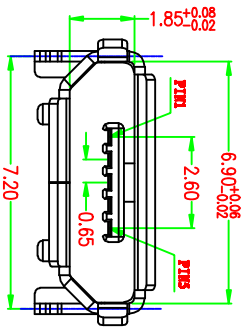
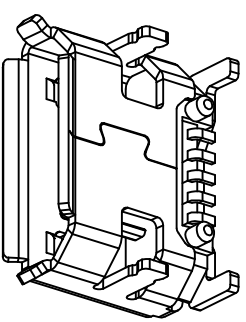
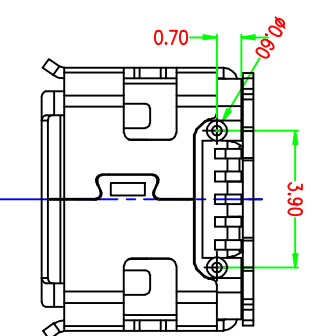
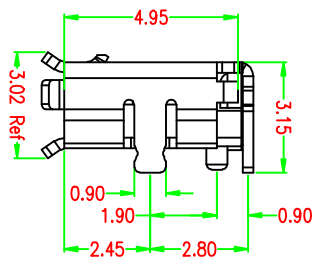
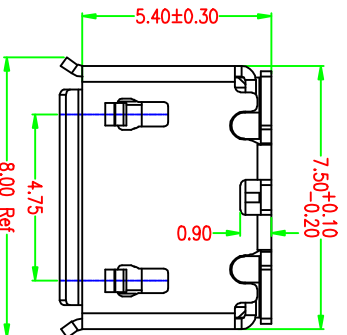
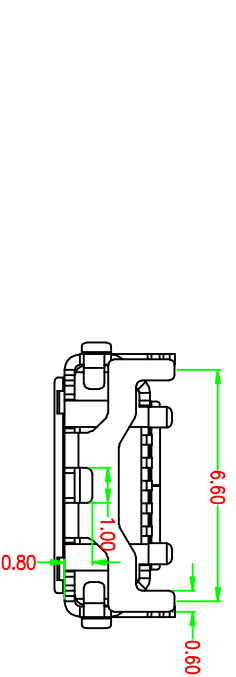

PCB 阻抗參考
RECOMMEND PCB LAYOUT

- Note:
- Material:
 - Housing: LCP High temperature thermoplastic with g.f.; UL94V-0
 - Contact: copper alloy; t=0.15mm
 - Shell: SUS304; t=0.30mm
 - Specification:
 - Current rating: 1.5PIN 1.8A Max/2,3,4PIN 1A Max.
 - Dielectric withstanding voltage: 100 V(ac) for 1 min.
 - Contact resistance: 30 mΩ Max.
 - Insulation resistance: 100 MΩ Min.
 - Total mating force: 3.57 Kgf Max.
 - Total unmating force: 1.0 Kgf Min.
 - Temperature range: -30°C~80°C

A 01 S B X X X X X X X X X X XX-184

- 1: 外部绝缘
- 2: 外部绝缘
- 3: 外部绝缘
- 4: 外部绝缘
- 5: 外部绝缘
- 6: 外部绝缘
- 7: 外部绝缘
- 8: 外部绝缘
- 9: 外部绝缘
- 10: 外部绝缘
- 11: 外部绝缘

PART NO. A01SBXXXXXX-184	MATERIAL: SSB NOTE	深圳市精拓金电子有限公司 TITLE: USB B TYPE母座规格书_007_有注册商標 DWG NO.: A184 SCALE: 5:1 DATE: 2012.07.13 REV: A	
MODEL NO: XX	FINISH: SSB NOTE		
UNIT: MM	SIZE: A4		
TOLERANCE UNSPECIFIED	DR: 1: Auto		
.X ±0.15	CHK:		
.XX ±0.10	APP:		
.XXX ±0.05			
Ang ±T			